



# City of Longview

## Agenda

### Parks and Recreation Board

---

Monday, February 23, 2026

5:00 PM

1525 Broadway  
Longview, WA 98632  
[www.ci.longview.wa.us](http://www.ci.longview.wa.us)

---

NOTICE IS HEREBY GIVEN, in accordance with RCW Chapter 42.30, that the Parks and Recreation Advisory Board of the City of Longview, Washington, will be holding a meeting on February 23, 2026, at 5:00 p.m. in the Training Room, on the 2nd floor of City Hall 1525 Broadway St., Longview. The meeting is also available online and/or via telephone.

### Microsoft Teams meeting

Join on your computer, mobile app or room device

[Click here to join the meeting](#)

Meeting ID: 229 956 634 565

Passcode: gSusnf

[Download Teams](#) | [Join on the web](#)

Or call in (audio only)

[+1 213-631-2692,,525776909#](#) United States, Los Angeles

[+1 347-973-4395,,525776909#](#) United States, New York City

Phone Conference ID: 525 776 909#

The City Hall is accessible for persons with disabilities. Special equipment to assist the hearing impaired is also available. Please contact the City Executive Offices at 360.442.5004 48 hours in advance if you require special accommodations to attend the meeting.

1. CALL TO ORDER
2. FLAG SALUTE
3. ROLL CALL
4. APPROVAL OF MINUTES  
26-00117 PRAB Draft Minutes 01.26.2026
5. CHANGES TO THE AGENDA
6. CONSTITUENT/BOARD MEMBER COMMENTS
7. OLD BUSINESS

**8. NEW BUSINESS****26-00168 A. Neighborhood Heroes - Facility Usage**

**SUMMARY:** Representatives from Neighborhood Heroes will present a proposal requesting formal recognition as a partner organization with Parks & Recreation and use of designated space within the Elks Building outside of peak summer programming hours. Neighborhood Heroes is a structured, one-on-one mentorship program modeled after Big Brothers Big Sisters, focused on building character, healthy identity, and future leaders rooted in the community. The program emphasizes youth safety through background screening, mandatory reporting requirements, supervision standards, and liability coverage. The organization proposes to utilize space during non-conflict hours (primarily evenings and select times outside summer peak programming) to provide supervised mentorship programming that aligns with Parks & Recreation standards, policies, and scheduling requirements. The presentation will outline:

- Program structure and mentor screening processes
- Community need and supporting data
- Insurance and liability coverage
- Proposed timeline (2026–2027)
- Anticipated benefits to Parks & Recreation and the broader community
- Measurable outcomes and evaluation metrics

This item is for presentation and discussion. The Board may provide feedback and direction regarding potential partnership and facility use.

**RECOMMENDED ACTION:** Motion to recommend that the Parks & Recreation Department explore a partnership agreement with Neighborhood Heroes for facility use, subject to staff review, scheduling availability, and compliance with all City policies and risk management requirements.

**STAFF CONTACT:** Justin Brown, Parks & Recreation Director

**26-00173 B. WSU Master Gardener - Lake Sacajawea Demo Garden Proposal**

**SUMMARY:** Washington State University Extension Master Gardeners will present a proposal for a demonstration garden at Lake Sacajawea. The proposal outlines the purpose of the garden, proposed location, general design elements, and anticipated partnership involvement. The presentation will also address maintenance expectations, funding considerations, and how the project would be implemented if approved. The Board will have the opportunity to ask questions and provide direction on whether to move forward with the proposal.

**RECOMMENDED ACTION:**

Move to support the concept of the Lake Sacajawea Demonstration Garden and direct staff to continue project planning and coordination.

**STAFF CONTACT:** Justin Brown, Parks & Recreation Director

**26-00170 C. Neighborhood Park Grant Applications**

**SUMMARY:** The Longview Parks & Recreation Neighborhood Park Grant Program provides capital improvement funding to support community-driven enhancements within the City's park system. The program is open to neighborhood groups, nonprofit organizations, community partners, and City-led initiatives seeking to improve park amenities, accessibility, and overall user experience. The City allocates \$25,000 annually for this program, with application cycles typically opening in January and June. If funds remain after external applications are reviewed, an additional internal

cycle may be opened for City-led park improvements. At this meeting, the Advisory Board will review submitted applications and have the opportunity to discuss and make a recommendation to City Council to allocate available funding to selected projects. The Board's recommendations will help ensure grant dollars are directed toward projects that align with community needs, adopted plans, and the long-term vision for Longview's park system.

Applicants:

1. Longview Pickleball Club
2. Longview Youth Soccer Association
3. Longview Youth Baseball

**RECOMMENDED ACTION:**

Motion to allocate the available Neighborhood Park Grant funding to eligible applicants in amounts and proportions as determined by the Board.

STAFF CONTACT: Justin Brown, Parks & Recreation Director

**26-00171 D. Lake Sacajawea Preservation Plan Update - Martin's Dock**

**SUMMARY:** Staff is initiating an update to the Lake Sacajawea Preservation Plan to ensure continued regulatory compliance and alignment with current community needs. The update will support evaluation of proposed improvements to Martin's Dock, including consideration of a performance shelter, while maintaining the historic and environmental integrity of the park. Staff will present the proposed scope and requested updates at this meeting and seek Board direction on how to proceed. Board members are encouraged to review the current plan in advance at: <https://www.mylongview.com/257/Park-Plans>. The specific recommended updates will be presented at the meeting and are not being distributed beforehand.

**RECOMMENDED ACTION:**

Motion to recommend that staff proceed with updating the Lake Sacajawea Preservation Plan as presented.

STAFF CONTACT: Justin Brown, Parks & Recreation Director

**9. REPORTS (10 Minutes)**

- 26-00174** A. Parks Maintenance/Urban Forestry Division Report  
B. Recreation Division Report  
C. Director's Report (Verbal)

**10. ADJOURNMENT**



# City of Longview

## Minutes

1525 Broadway  
Longview, WA 98632  
www.ci.longview.wa.us

### Parks and Recreation Board

---

Monday, January 26, 2026

5:00 PM

---

1. **CALL TO ORDER**

*The meeting was called to order at 5:01 PM*

2. **FLAG SALUTE**

3. **ROLL CALL**

*Members Present: Board Member Jenny Oskey, Board Member Oliver Black, Board Member Glenda Johnson, Board Member Steven Pond, Board Member Manon Kaufman*

*Members Absent:*

*Constituents Present: Devon Henthorn & David Eaker*

*Council Members Present: Wayne Nichols*

*Staff Present: Erin Cranston, Melissa Harbour, Alissa Manno*

4. **APPROVAL OF MINUTES**

**25-001131 PRAB Draft Meeting Minutes 12.15.2025**

*A motion was made by Board Member Johnson and seconded by Board Member Kaufman to accept the minutes as provided. The motion passed with the following vote:*

*Ayes: Jenny Oskey, Oliver Black, Glenda Johnson, Steven Pond, Manon Kaufman*

*Yes 5, No 0, Abstained 0*

5. **CHANGES TO THE AGENDA**

*N/A*

6. **PRESENTATIONS**

**26-0062 2025 Progress Update - Longview Girls Softball**

*David Eaker & Devin Henthorn from Longview Girls Softball Association provided an update on the 2025 Season.*

**26-0063 Cloney Park Project Update - Alissa Manno**

*Alissa Manno, Recreation Specialist, presented on Cloney Park Inclusive Playground.*

7. **CONSTITUENT/BOARD MEMBER COMMENTS**

*Glenda Johnson provided comments.*

8. **OLD BUSINESS**

**9. NEW BUSINESS****25-001132 A. Election of Chair & Vice Chair**

**SUMMARY:** Per the Bylaws, an election shall take place each year to select a chair and vice-chair of the board.

**RECOMMENDED ACTION:** Seeking a motion to elect both chair & vice-chair.

**STAFF CONTACT:** Erin Cranston, Recreation Manager

*A motion was made by Board Member Johnson to retain Oliver Black as Chair and nominate Manon Kaufman as Vice Chair. The motion passed with the following vote:*

*Ayes: Jenny Oskey, Oliver Black, Glenda Johnson, Steven Pond, Manon Kaufman  
Yes 5, No 0, Abstained 0*

**26-0064 B. Update to Bylaws**

**SUMMARY:** Periodically the bylaws are reviewed and revised where applicable. Additionally, staff was asked to revise for the potential addition of a student member.

**RECOMMENDATION:** Review and provide a motion to update bylaws with agreed-upon revisions.

**STAFF CONTACT:** Erin Cranston, Recreation Manager

*A motion was made by Board Member Johnson and seconded by Board Member Oskey to approve the changes to the Bylaws as recommended, with any needed additional input.*

*Board Member Pond made an amended motion to change the wording for residents. Chairperson Black seconded the motion. The motion passed unanimously.*

*A motion was made by Board Member Pond and seconded by Board Member Johnson to add a Parks & Recreation Foundation Board Member to the Ex-Officio section of the Bylaws. The motion passed unanimously.*

*\*Action Item: Recreation Manager Erin Cranston will update the Bylaws as suggested and send them out, and submit to City Council for approval.*

*Ex-offio members for 2026*

*Parks & Recreation Foundation Board ~ Glenda Johnson (Chairperson Black will potentially take over after further consideration)*

*Planning Commission ~ Steven Pond*

**10. REPORTS (10 Minutes)****26-0061 A. Parks Maintenance/Urban Forestry Division Report (Embedded)**

**B. Recreation Division Report (Embedded)**

**C. Director's Report (Verbal)**

*A Parks Division Report was embedded in the agenda.*

*A Recreation Division Report was embedded in the agenda.*

**11. ADJOURNMENT**

*The meeting was adjourned at 06:15 PM. The next meeting is scheduled for February 23, 2026.*

# NEIGHBORHOOD HEROES

Intentional 1-On-1 Mentorship



Building strong character, healthy identity  
And future leaders - rooted in their community.

# What Is Neighborhood Heroes?

Neighborhood Heroes is a sports-inspired BIG Brother BIG Sister program.  
Built around consistent and positive adult relationships.

□ Structured Mentorship □ Supervised Recreation □ Leadership Development

Providing additional support for youth who may benefit BEYOND traditional group activities and/or sports.

## **SAFETY is our PRIORITY**

- Clear code of conducts, policies and supervision standards.
- Activities conducted in approved and supervised environments .
- Mandatory reporting requirements.
- Youth protection & abuse prevention.

# Liability & Insurance

- **Neighborhood Heroes carries organizational liability insurance through United States Liability Insurance (USLI).**
- **Insurance coverage applies to all Neighborhood Heroes programming and mentors**
- **Coverage extends to activities conducted as part of the approved partnership**

# Mentor Oversight

- In Addition to mandatory onboarding and training -

All mentors are background checked and screened for the following through Praesidium:

- Multi-state criminal search
- National sex-offender search
- SSN trace
- Alias search
- County-level search (most relevant)

# Understanding The Problem

Population (2024 estimate): 113,980 people in Cowlitz County.

22.1% of residents are under age 18, meaning youth make up a large segment of our community.

- Nearly 1 in 6 children in Cowlitz County lives in poverty, increasing risk for academic struggle, behavioral issues, and disconnection.
- Local child welfare data shows higher-than-average child abuse rates in the county, indicating trauma exposure among youth who need support.
- Opportunity youth (ages 16–24 not in school or work) approximately 1,927 individuals in our region, including Cowlitz, showing youth disconnection, that extends into young adulthood.

Bottom line: Youth here face economic, social, and emotional barriers that deeply affect outcomes for their future.

These are conditions that make mentorship necessary.

# The **POWER** of mentorship:

▫ Mentored youth are 52% **less** likely to skip school.

▫ Mentored youth are 46% **less** likely to start using drugs.

- 40% of young people grow up without ever having a mentor, and 67% report needing a mentor at some point in their life, but not having one.
- Approximately 16 million youth never had any kind of mentor, including 9 million at-risk youth — showing a major gap mentors can fill.

Many youth in our community lack stable adult relationships.

Whether due to family disruption, economic stress, grief, or lack of positive role models, these kids often fall through the cracks of large group programs.

Neighborhood Heroes exists to close that gap.

# CREDIBLE COMMUNITY DATA



- **Cowlitz County Public Health Department**
  - **Washington State Department of Health**
  - **Centers for Disease Control and Prevention (CDC)**
  - **Office of Superintendent of Public Instruction (OSPI)**
  - **Local school district and community partner reports**
-

# THE ASK

*Neighborhood Heroes* is requesting formal recognition as a partner organization with Parks & Recreation, along with defined access to designated spaces within the Elks Building outside of the summer programming period to deliver intentional and structured, supervised youth programming.

This access would allow Neighborhood Heroes to conduct mentor training and onboarding, after-school activities, and regularly scheduled teen nights, including controlled and fully staffed use of the basketball courts for supervised games and use of the kitchen for program meals, group dinners and home economics for the youth.

During the summer months (June–August), *Parks & Recreation* would retain program authority and oversight, with Neighborhood Heroes providing approved mentorship and staffing support. This partnership would enable Neighborhood Heroes to offer consistent, year-round mentorship and youth engagement programming that complements and strengthens Parks & Recreation services while adhering to all facility rules, safety standards, and scheduling requirements.

# For Parks & Rec

- Enhanced youth engagement with existing programs.
  - Stronger behavior and support outcomes — less disruption.
  - Increased relevancy as a community safety and youth development hub.
  - More support for grant reporting and measurable impact data.
-

# For Neighborhood Heroes



A dedicated facility allows us to:

- Train and supervise mentors properly.
- Safely match and support youth long-term.
- Operate with full compliance and accountability.
- Shared spaces + shared mission = greater community impact.

Together, we can make the Elks Building not just a place to play, but a place to thrive.

---

# Measurable Success

## What We Will Track Together

- Youth participation rates in joint programs.
- Parks & Rec staff observations and feedback.
- Behavioral improvements based on check-ins.
- Parent/caregiver satisfaction.

## What Neighborhood Heroes Tracks

- Community & Program Impact.
- Personal Growth & Life Skills.
- Engagement & Consistency.
- Behavior & Accountability.

This is Low-risk High-impact start - that can grow over time.

# Current Community Involvement

## LION HOUSE

NH Heroes Program

- Introduction to Muay-Thai Kick-Boxing
- Self defence - Mentorship

## Cutz4Kidz

NH Heroes Program

- Free Youth Haircuts
- Boosts self confidence and supports community connections.

## Central Sandlot

- Program Coordinator - 6 week summer camp
- Introduction to baseball ages 6-12

## YMCA

- Teen Nights
- Community Partnership
- Connecting with local teens.

# Timeline 2026-2027

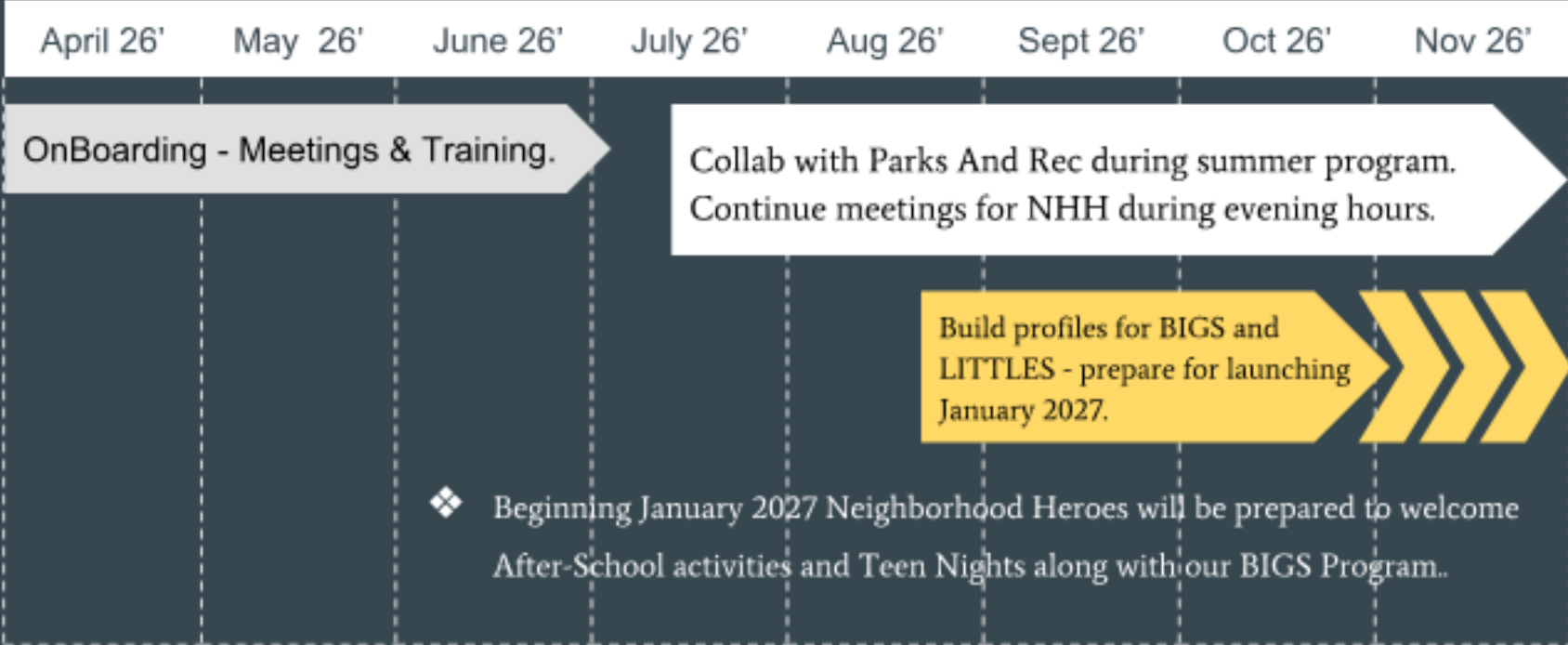

# Meet Our Growing Team

Tyler Hogman, CEO

-Founder -

Leads strategic vision, oversees all programs and partnerships, chairs board meetings.

Trisha Johnson, OBS

-On-Boarding Specialist -

Screens, trains, and supports new mentors and volunteers.

Nate Tanzmen, YAC

-Youth Advisory Committee-

Advises on youth engagement, planning, and leadership.

Janice Heinz

-Treasure-

Manages financial matters, budget reporting, compliance, and liaison with bookkeepers. (Cowlitz bookkeepers)

# Proposed Demo Garden at Lake Sacajawea

**This proposal is for the Cowlitz County WSU Extension Master Gardeners to partner with the City of Longview Parks and Recreation Department to adopt and create a children's demonstration garden at Lake Sacajawea/Longview Arboretum behind the Elk's Memorial Building.**





2025

# WSU Extension Cowlitz County Master Gardener Program

## BY THE NUMBERS

**125** VOLUNTEERS  
**12,302** VOLUNTEER HOURS  
**\$ 522,084** ECONOMIC VALUE\*

\*Based on Independent Sector "Value of Volunteer Time" in WA State.



Educational Contact  
with Cowlitz County

**6,677**

**ADULTS & YOUTH**

### Questions answered about:



4



4



1



62



6



**105** CLINICS

**475** VOLUNTEER HOURS

**314** CLIENTS

**218** QUESTIONS ANSWERED



3



61



36



45



35

**76**  
PUBLIC  
PRESENTATIONS  
**1,308**  
ATTENDEES



WSU EXTENSION  
**Cowlitz County**

WSU Extension Master Gardeners are a volunteer community of educators –cultivating plants, people, and communities since 1973. We are a 501(c)3 nonprofit educational organization. We aim to support a sustainable and healthy community by raising funds, planning and hosting educational projects and workshops, and expanding awareness of the WSU Cowlitz County Master Gardener outreach programs.

# Here's an example of what we do:

**We operate four demonstration gardens in Cowlitz County.**

- Living classrooms (Ex. fruit tree and grape pruning)
- Youth gardening classes
- Informal tours
- Demonstrations (Ex. composting, raised bed gardening, native plantings)



**Washington State University Cooperative Extension -  
Master Gardener Demonstration Garden**

Entrance to WSU Extension Master Gardeners Demonstration Garden.

# Demo Garden at Mt. St. Helens Visitors Center

## A living showcase of Pacific Northwest natives.

- Demonstrates how homeowners can design gardens that are both stunning and sustainable
- Supports local pollinators
- Low maintenance
- Drought tolerant



# Location: Lake Sacajawea



Elk's Building



# Our Vision: Two Phases

## Phase 1:

- Refurbishing raised bed area
- Plantings with “kid-friendly” veggies and fruits
- Adding interactive “play” structures to provide visual interest

## Phase 2:

- Development of walking garden (between fence and lake)
- Including pathways, benches, Native plantings, and educational signage
- Potential partnership with local Native American tribe



# Goals

## Two main purposes:

- Education community, primarily children
- Greater presence in Longview

## Additional benefit:

- Use of Elk's building and/or LV Women's building for classes and/or demonstrations

# Timeline

April - May 2026: Phase 1

- Refurbishing raised beds
- Adding new corrugated metal beds
- Adding soil/compost
- Installing drip-irrigation
- Storage shed

June- Oct 2026: Phase 1 continued

- Weekly presence planting and maintaining garden, working with children
- Plantings focus on kid-friendly fruits, veggies, and flowers

Spring 2027: Begin work on Phase 2

# Budget (Phase 1 only)

soil/compost (8 cu.yds Super Soil)	\$1600
Treated wood for raised beds	\$1600
Metal corrugated beds (3 8x4 rectangular, 2 42" circular, and 2 24" circular)	\$1400
Weed barrier fabric	\$125
Irrigation (drip system)	\$1300
Garden Shed (6'x5' resin shed w/shelving, tool hangers, and lock)	\$1100
Play structures (chimes)	\$600
Tools (adults and children sized)	\$350
Signage (2-18"x12" w/graffiti protect)	\$150
Plants/seeds	\$250
Fertilizer/treatments	\$100
Teaching materials	\$200
Plant labels	\$100
<b>Total</b>	<b>\$8,875</b>

## Support Requested:

We ask that the City of Longview provide the necessary **water** to the garden as necessary. We will also occasionally need to have access to **electricity** via an existing plug by the outside restrooms.

We are also hoping to occasionally have use of the Elk building and/or the Longview Women's Club building (across the street) when available in order to host gardening classes for the community.

# Photos of existing garden





This is where we'd like to place a storage shed for tools and supplies.

# Inspirational photos of WSU Extension Master Gardener **Children's Garden** in **Kennewick, WA**





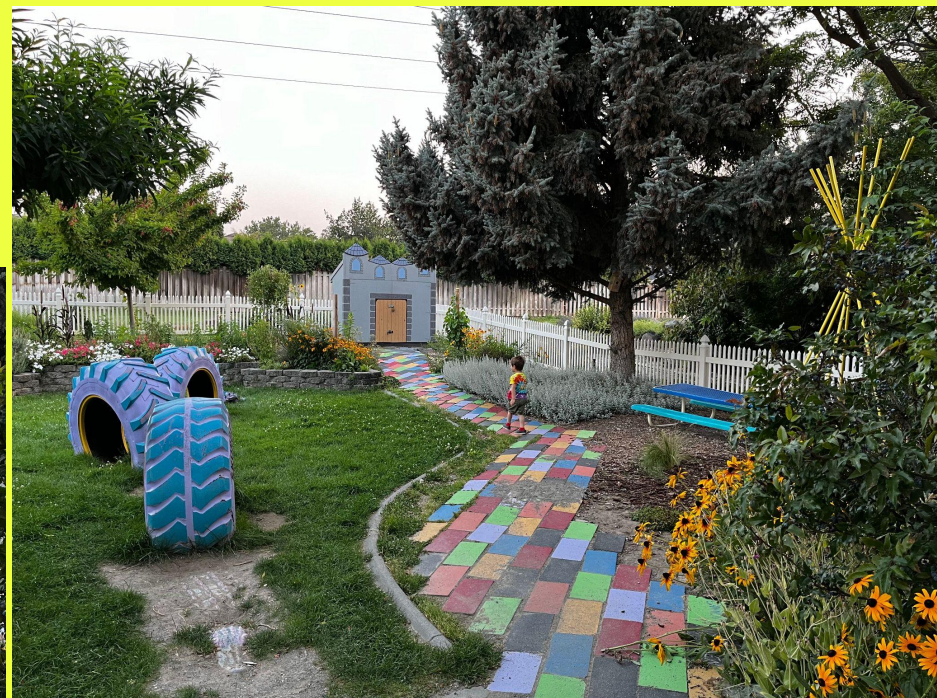

# Suggested layout design of garden beds / play area

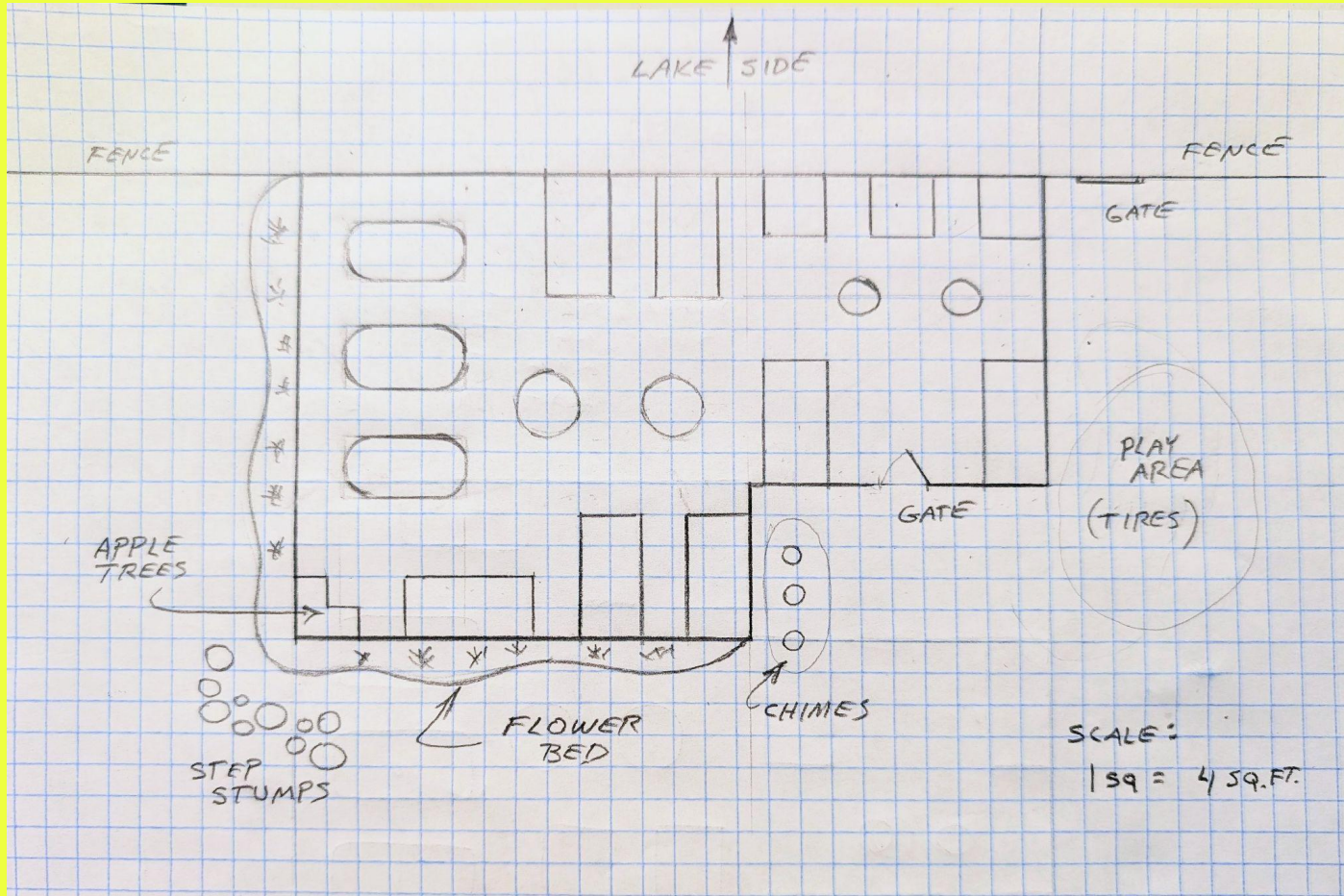

# Conclusion

- **Why this garden matters: Our vision**
  - Educating and engaging children (and the community) is central to this project
  - Our goal is to help create gardeners for life
  
- **Benefits for children:**
  - Builds confidence and self-esteem
  - Encourages responsibility through caring for living things
  - Provides therapeutic benefits (reduced anxiety, improved mood, connection to nature)
  - Promotes healthy eating (children are more likely to try foods they grow themselves)

We hope that you will consider this partnership and approve this proposal.

**NEIGHBORHOOD PARK GRANT APPLICATION ASSESSMENT - BEGIN ASSESSMENT HERE:**

<b>8 Rating Criteria</b>	<b>Did Applicant Address Criteria?</b>	<b>Score</b>	<b>Notes</b>
<b>Need:</b> Score based on presence of similar or complementary facilities in the area/community as well as level of need. The greater the need, the higher the score. <b>(10 Points)</b>	<input type="checkbox"/> YES <input type="checkbox"/> NO		
<b>Community Impact:</b> Score based on number of people affected, diversity, and underserved populations. The bigger the impact, the higher the score. <b>(10 Points)</b>	<input type="checkbox"/> YES <input type="checkbox"/> NO		
<b>Access:</b> Score based on public availability and year-round access, the more access, the higher score. <b>(10 Points)</b>	<input type="checkbox"/> YES <input type="checkbox"/> NO		
<b>Financial Responsibility:</b> Score based on longevity and impact on maintenance and upkeep. The longer it lasts, the less impact on the ongoing park budget /staffing time, the higher the score. <b>(10 Points)</b>	<input type="checkbox"/> YES <input type="checkbox"/> NO		
<b>Cost Benefit:</b> Score based on economic impact, community development, play opportunities, and youth issues reduction. The larger the benefit provided, the higher the score. <b>(10 Points)</b>	<input type="checkbox"/> YES <input type="checkbox"/> NO		
<b>Compliance:</b> Score based on adherence to city policies, preservation plans, and comprehensive plans. The more the project complies, the higher the score. <b>(10 Points)</b>	<input type="checkbox"/> YES <input type="checkbox"/> NO		
<b>Readiness to Proceed:</b> Score based on preparedness for installation. If the project is prepared to install or a secure plan is in place, the higher the score. <b>(20 Points)</b>	<input type="checkbox"/> YES <input type="checkbox"/> NO		
<b>Funding:</b> Score based on availability of funding or plan for securing including letters of intent from donors/partners. <b>(20 Points)</b>	<input type="checkbox"/> YES <input type="checkbox"/> NO		
	<b>Total Points:</b>	<u>          </u>	



# Longview Parks and Recreation Department Neighborhood Park Grant Application

Application deadline: February 18, 2026

PLEASE SUBMIT EIGHT (8) COPIES OF THIS APPLICATION AND EIGHT (8) COPIES OF ANY SUPPLEMENTAL MATERIALS

1/30/26	Project Name Court Resurfacing	Project Location Vandercook Courts
Applicant (organization) Longview Pickleball Club		Contact Person and Title Eric Wilson
Are you a non-profit organization? <input checked="" type="checkbox"/> Yes <input type="checkbox"/> No		If yes, what is your IRS Tax ID#? 30-1430237
Address P.O. Box 414		City/State/Zip Longview, WA 98632
Daytime Phone 360-600-0616	Evening Phone 360-600-0616	Email Address eric@wilsondentalarts.com

**Project Description.**  
(Applicants are encouraged to attach additional pages including schematic drawings, site location drawings, maps, pictures, and photographs.)

See attached  
Repair + surfacing existing courts

### Project Relationship to Grant Rating and Instruction Criteria

(On a separate sheet of paper please explain how this project responds to the eight rating criteria listed in the application process. Addressing the eight criteria will enable the Parks and Recreation Advisory Board to evaluate the importance of the project against others that request funding. Failure to address the criteria will result in an incomplete application and request denial.)

- Need:** Does the community have a need for this project? (Consider whether there are similar or complementary facilities in the area/community)
- Community Impact:** Who will benefit from the project? Provide approximate number, range, and diversity of those likely to be served by or benefit from the project? Do they represent a significant underserved population?
- Access:** Upon completion, what will the availability of the project be to the public during the year?
- Financial Responsibility:** What is the potential life span of the project? What will the maintenance and replacement requirements of the project be, both immediate and long-term?
- Cost Benefit:** Do the benefits outweigh the cost of the project? (Benefits include economic impact and community development, additional opportunities for play in the community, and reduction in youth related social problems.)
- Compliance:** Does the project comply with the City of Longview's historic preservation plan, park and recreation comprehensive plan, and other city policy initiatives?
- Readiness to Proceed:** How soon after the grant is approved can the project begin? (Discuss how quickly the applicant can complete the project by demonstrating availability of the required financial match; permits being secured; and availability of needed labor.)
- Funding:** What are the applicant's potential sources of funding? (Please list all cash and in-kind goods and services) Are they already secured? Does the applicant identify partnership arrangements and what value does the partnership(s) bring to the project?

# Project Budget and Funding

## ESTIMATED BREAKDOWN OF THE PROJECT

Provide Quotes and List of Supplies	COST OF PAID SUPPLIES	\$ 0	%
Provide Quotes and Business Information	COST OF PAID SERVICES	\$ 29,582.00	%
Provide Estimated Number and Hours	HOURS OF VOLUNTEER LABOR	\$ 0	%
Provide Quotes and List of Supplies	COST OF DONATED SUPPLIES	\$ 0	%
Provide Quotes and Business Information	COST OF DONATED SERVICES	\$ 0	%
<b>TOTAL COST OF THE PROJECT:</b>		<b>\$ 29,582.00</b>	

## TOTAL CASH/DONATIONS AT TIME OF APPLICATION - READINESS TO PROCEED

SECURED APPLICANT CASH:	\$ 29,582.00	%
*(Monetary value of all donations) SECURED APPLICANT DONATIONS:	\$ 0	%
*(Monetary value: 1 Hour = \$15.00) VOLUNTEER LABOR DONATION COMMITMENT: *	\$ 0	%

# of Volunteers X \_\_\_\_\_ # of Hours Donated = \_\_\_\_\_ Total Hours of Volunteer Labor Donations

**TOTAL OF SECURED FUNDING/DONATION FOR THE PROJECT:** \$ 29,582.00

If the total of secured funding, including donations, does not equal the total cost of the project please provide below the timeline and steps that will be taken to ensure readiness to proceed.

## APPLICANT REQUEST: 50% REIMBURSEMENT OF EXPENDED FUNDS

Applicants may use cash, in-kind donations and services, and volunteer labor hours to account for the total cost of the project. Matching grant funds are only available for reimbursement on actual expenditures spent on supplies and services and not on donated items or labor.

**GRANT FUNDS REQUESTED FROM CITY OF LONGVIEW:** \$ 15,000.00

## ADDITIONAL PROJECT QUESTIONS

Will fees be charged in connection with using this project? <input type="checkbox"/> Yes <input checked="" type="checkbox"/> No If yes, please describe:	Multi-year project? <input type="checkbox"/> Yes <input checked="" type="checkbox"/> No (If yes, please describe)
--	---

Anticipated Start Date: June 1, 2026      Anticipated Date of Completion: June 30, 2026

Application completed by (print and sign name) Brenda Bible      Title Treasurer      Date 2/14/26

Please return this application by February 18, 2026 to:

**City of Longview**  
**Parks and Recreation Department**  
**2920 Douglas St.**  
**Longview, WA 98632**



# NEIGHBORHOOD PARK GRANT ESTIMATE WORKSHEET - VOLUNTEER COMMITMENT

DATE	PRINTED NAME	WORK DESCRIPTION	HOURS COMMITTED	SIGNATURE
	n/A			
			<b>TOTAL NUMBER x \$15.00</b>	

\* Volunteer Labor is calculated at \$15 per hour. Volunteer Register must match dollar amount provided for in project total.  
 \* Additional registers are available upon request if more pages are needed.

TOTAL PROJECT SUMMARY		
A.	TOTAL EXPENDITURES	\$
B.	TOTAL IN-KIND DONATIONS	\$
C.	TOTAL VOLUNTEER LABOR	\$
<b>TOTAL PROJECT COST:</b>		<b>\$</b>

Transfer all totals from the two "Estimate Worksheets" to the table on the left for a summary of the total project cost, then transfer totals to the Project Budget and Funding page.

TOTAL REQUEST FOR REIMBURSEMENT	
REQUEST:	\$

By my signature below, I certify the information I provided on and in connection with this form is true, accurate, and complete. I also understand that any false statements or deliberate omission on this document or attached documents I submit for the Neighborhood Park Grant Program may be grounds for disqualification for reimbursement.

ORGANIZATION NAME	PRINTED NAME:	SIGNATURE:	DATE:

The Longview Pickleball Club (referred to as the “Club”) has a history of partnering with The City of Longview (referred to as “the City”) by providing new and improved pickleball courts for the growing Longview community, which is projected to continue to grow 3% annually. The Club plans to partner once again with the City on a Capital Improvement Project to upgrade the Tennis and Pickleball Courts at Vandercook Park.

Vandercook Park was established around 1998. While still functional today, the courts need an upgrade, including repairs and resurfacing. The City has projected this upgrade for 2028, yet the Club is ready to act now, with immediate revenue, to resurface and upgrade the courts. The Club has received 2 proposed bids for court resurfacing, which have been included in this proposal. At this time, the only need that would affect our readiness is obtaining the necessary permits through the City and signing a contract with the selected company. The Club desires to contract with Pacific Ace LLC, which the Club hired to complete the John Null courts, and has been extremely satisfied with their work. Although this is desired, we are open to planning with the City to ensure that this project complies with historic preservation, comprehensive planning, and other city policy initiatives. Currently, the Club feels that the projected bid meets these explicit requirements. This resurfacing will not change the park in any significant way that would be contrary to these requirements.

The Club holds an annual pickleball tournament to raise funds for court improvements and capital projects for the Longview area. This annual 4-day tournament generates revenue for the City in several ways: by using local food and coffee vendors, by attracting visitors to the surrounding businesses, and, most importantly, by tournament entry fees that are reinvested in the city, including for this proposed project. The Club has currently budgeted with board approval, \$30,000 for this improvement project, if selected by the City.

Although Longview already has Pickleball courts at John Null Park, it is less accessible than the more centrally located Vandercook Park, which meets the needs of our community members who are more centrally located, our economic community of the downtown area, and the diverse community around the area that may have more difficulty accessing the John Null Park. Vandercook is classified as a neighborhood park, accessible by many roadways in Longview, within walking distance of Lake Sacajawea and the surrounding residential area with diverse households.

The Vandercook courts are open to the public year-round for tennis play, in addition we offer portable pickleball nets available to Club members through a lockbox system. There are currently no permanent pickleball nets at Vandercook. The Club recently purchased 2 new portable nets to be used at Vandercook for Club pickleball play and they will be established in Spring 2026. At this time, the nets are not accessible to all community

members due to the risk of asset loss valued at \$2600.00. Again, they are accessible by being a Club members.

The Longview Pickleball Club is open to anyone to join on an annual basis. By joining the Club provides access to lockboxes at both John Null and Vandercook Park. Within these boxes there are paddles, balls, a first aid kit, an AED, appropriate court cleaning tools, lost and found items, and portable nets at Vandercook only. The Club dues are \$20.00 annually per person and \$18.00 for ages 17 and under. This small fee has not been increased since the club was established to keep it affordable. This income allows the Club to maintain the contents of the lockbox for members and minor court maintenance when needed. This fee and the lock boxes are in no way intended to limit community members' access to the court; they are a means to secure court supplies and safeguard the equipment from theft or damage. Pickleball is for all ages; we encourage our young community members to play on the courts. The club is currently looking into holding a free or low-cost kids pickleball clinic to encourage our young community members by teaching the rules and mechanics of the game. We encourage our young community members to join the club.

The club has a strong community presence and high usage of the pickleball courts. We anticipate continued growth in our club and tournament revenue; with this, we will continue to invest in maintaining or helping maintain the courts as needed. To date we club has maintained the John Null Courts

We look forward to our future partnership

Longview Pickleball Club Board & Members

**PACIFIC ACE LLC**

Surfacing Solutions

www.pacificace.net

Scott Havens

503-320-8276

alex.havens@gmail.com

3631 NE 36th Ave  
Vancouver, WA 98661

www.pacificace.net  
pacificace.llc@gmail.com

November 22, 2025

Scott Havens C 503-341-7641  
ascott@havens@gmail.com

**CUSTOMER:**

Vandercook Park, Longview, WA  
Eric Wilson  
360-600-0616  
eric@wilsonentertain.com

CLIENT	LOCATION	PROJECT TERMS	INSTALL
Scott Havens	See above	TBA	summer '26

QTY	DESCRIPTION	UNIT	UNIT PRICE	TOTAL
	Existing tennis/pickleball court			
	two existing tennis courts, convert to 4 PB courts			
	light green and dark blue play area pickle.			
	light blue kitchen.			
	size 120X120			
180	180 LF crack repair with RiteWay	ea	23.00	4,140.00
	Surfacing, Plexipave, 1 Acrylic resurfacer and 3 fortified color coats (3 colors plus white lines)			23,200.00
	pickle WHITE LINES			
	Tennis lines color TBA			
	Privately funded, not prevailing wage.			
	Sales tax 8.2%			

**SUB TOTAL:** 27,340.00  
**SALES TAX:** 2,242.00  
**GRAND TOTAL:** 29,582.00

Scott Havens 503-341-7641  
alex.havens@gmail.com 503-320-8276  
PACIFIC ACE LLC

ACCEPTED

DATE

# Centre Court Sport Surfaces LLC

609 NE 146th St.

Vancouver, WA. 98685

360.784.0212

360.838.3175

centrecourtsportssurfaces@gmail.com

BID TO

Eric Wilson - Vandercook Park Courts

360.600.0616

1416 21st Ave, Longview, WA 98632

eric@wilsondentalarts.com

[Redacted] 12/23/2025

[Redacted] BID # 12232025-400

DESCRIPTION	QTY	UNIT PRICE	AMOUNT
Item 1 Prep and prepare surface 120x120	1		
Item 2 Clean and blow out all cracks	1		
Item 3 Fill and clean all cracks, bird baths and sand surface	1		
Item 4 Tape off court and apply adhesion promotor	1		
Item 5 Apply two coats acrylic resurfacer	1		
Item 6 Scrape, clean court and blow off court	1		
Item 7 Apply two coats of acrylic colorplus	1		
Item 8 Line out all courts	1		
Item 9 Prime lines. Paint lines and clean up	1		
Item 10 Mobilization and Trash	1		
Item 11 Labor and materials	1		
Item 12			

*Thank you for your business!*

SUBTOTAL	49,920.50
TAX RATE	8.200%
TAX	4,093.48
<b>TOTAL</b>	<b>\$ 54,013.98</b>

The estimate is based on information provided from the customer regarding project requirements.

Actual cost may change once all project elements are finalized.

Prior to any changes of cost, the customer will be notified. Bid valid for 30 days. 50% Down Payment shows acceptance of this bid and is required to have your time slot inputted into the Centre Court Sport Surfaces LLC Schedule

Customer acceptance signature: \_\_\_\_\_ Date: \_\_\_\_\_

**NEIGHBORHOOD PARK GRANT APPLICATION ASSESSMENT – BEGIN ASSESSMENT HERE:**

<b>8 Rating Criteria</b>	<b>Did Applicant Address Criteria?</b>	<b>Score</b>	<b>Notes</b>
<b><u>Need:</u></b> Score based on presence of similar or complementary facilities in the area/community as well as level of need. The greater the need, the higher the score. <b>(10 Points)</b>	<input type="checkbox"/> YES <input type="checkbox"/> NO		
<b><u>Community Impact:</u></b> Score based on number of people affected, diversity, and underserved populations. The bigger the impact, the higher the score. <b>(10 Points)</b>	<input type="checkbox"/> YES <input type="checkbox"/> NO		
<b><u>Access:</u></b> Score based on public availability and year-round access, the more access, the higher score. <b>(10 Points)</b>	<input type="checkbox"/> YES <input type="checkbox"/> NO		
<b><u>Financial Responsibility:</u></b> Score based on longevity and impact on maintenance and upkeep. The longer it lasts, the less impact on the ongoing park budget /staffing time, the higher the score. <b>(10 Points)</b>	<input type="checkbox"/> YES <input type="checkbox"/> NO		
<b><u>Cost Benefit:</u></b> Score based on economic impact, community development, play opportunities, and youth issues reduction. The larger the benefit provided, the higher the score. <b>(10 Points)</b>	<input type="checkbox"/> YES <input type="checkbox"/> NO		
<b><u>Compliance:</u></b> Score based on adherence to city policies, preservation plans, and comprehensive plans. The more the project complies, the higher the score. <b>(10 Points)</b>	<input type="checkbox"/> YES <input type="checkbox"/> NO		
<b><u>Readiness to Proceed:</u></b> Score based on preparedness for installation. If the project is prepared to install or a secure plan is in place, the higher the score. <b>(20 Points)</b>	<input type="checkbox"/> YES <input type="checkbox"/> NO		
<b><u>Funding:</u></b> Score based on availability of funding or plan for securing including letters of intent from donors/partners. <b>(20 Points)</b>	<input type="checkbox"/> YES <input type="checkbox"/> NO		
	Total Points:	_____	



Longview Parks and Recreation Department  
**Neighborhood Park Grant Application**

Application deadline: February 18, 2026

**PLEASE SUBMIT EIGHT (8) COPIES OF THIS APPLICATION AND  
 EIGHT (8) COPIES OF ANY SUPPLEMENTAL MATERIALS**

Date	Project Name	Project Location
2/17/2026	LYB Cage Turf and Bleachers	John Null Park
Applicant (organization)		Contact Person and Title
Longview Youth Baseball		Aaron Marthaller - President
Are you a non-profit organization?		If yes, what is your IRS Tax ID#?
<input checked="" type="checkbox"/> Yes <input type="checkbox"/> No		47-3728230
Address		City/State/Zip
2650 Pacific Way		Longview, WA 98632
Daytime Phone	Evening Phone	Email Address
360-431-9013	Same	PresidentLYB@Gmail.com

**Project Description.**

*(Applicants are encouraged to attach additional pages including schematic drawings, site location drawings, maps, pictures, and photographs.)*

The proposed project includes replacing old wooden and steel bleacher seating with new safe aluminum IBC and ICC compliant bleacher seating. In addition, the proposed project includes the addition of new turf in the batting cages (over new concrete flooring). These projects will improve and enhance the access and safety for youth athletes, volunteers, parents, and the viewing public.

**Project Relationship to Grant Rating and Instruction Criteria**

**(On a separate sheet of paper please explain how this project responds to the eight rating criteria listed in the application process. Addressing the eight criteria will enable the Parks and Recreation Advisory Board to evaluate the importance of the project against others that request funding. Failure to address the criteria will result in an incomplete application and request denial.)**

- Need:** Does the community have a need for this project? (Consider whether there are similar or complementary facilities in the area/community)
- Community Impact:** Who will benefit from the project? Provide approximate number, range, and diversity of those likely to be served by or benefit from the project? Do they represent a significant underserved population?
- Access:** Upon completion, what will the availability of the project be to the public during the year?
- Financial Responsibility:** What is the potential life span of the project? What will the maintenance and replacement requirements of the project be, both immediate and long-term?
- Cost Benefit:** Do the benefits outweigh the cost of the project? (Benefits include economic impact and community development, additional opportunities for play in the community, and reduction in youth related social problems.)
- Compliance:** Does the project comply with the City of Longview's historic preservation plan, park and recreation comprehensive plan, and other city policy initiatives?
- Readiness to Proceed:** How soon after the grant is approved can the project begin? (Discuss how quickly the applicant can complete the project by demonstrating availability of the required financial match; permits being secured; and availability of needed labor.)
- Funding:** What are the applicant's potential sources of funding? (Please list all cash and in-kind goods and services) Are they already secured? Does the applicant identify partnership arrangements and what value does the partnership(s) bring to the project?

## Project Budget and Funding

### ESTIMATED BREAKDOWN OF THE PROJECT

Provide Quotes and List of Supplies	<b>COST OF PAID SUPPLIES</b>	\$ 35,829.99	%
Provide Quotes and Business Information	<b>COST OF PAID SERVICES</b>	\$	%
Provide Estimated Number and Hours	<b>HOURS OF VOLUNTEER LABOR</b>	\$	%
Provide Quotes and List of Supplies	<b>COST OF DONATED SUPPLIES</b>	\$	%
Provide Quotes and Business Information	<b>COST OF DONATED SERVICES</b>	\$	%

**TOTAL COST OF THE PROJECT:** \$ 35,829.99

### TOTAL CASH/DONATIONS AT TIME OF APPLICATION - READINESS TO PROCEED

<b>SECURED APPLICANT CASH:</b>	\$ 35,829.99	%
*(Monetary value of all donations) <b>SECURED APPLICANT DONATIONS:</b>	\$	%
*(Monetary value: 1 Hour = \$15.00) <b>VOLUNTEER LABOR DONATION COMMITMENT: *</b>	\$	%

\_\_\_\_\_ # of Volunteers X \_\_\_\_\_ # of Hours Donated = \_\_\_\_\_ Total Hours of Volunteer Labor Donations

**TOTAL OF SECURED FUNDING/DONATION FOR THE PROJECT:** \$ 35,829.99

**\* If the total of secured funding, including donations, does not equal the total cost of the project please provide below the timeline and steps that will be taken to ensure readiness to proceed.**

LYB currently has the funds to complete this project in our account at Red Canoe Credit Union and can proceed immediately.

### APPLICANT REQUEST: 50% REIMBURSEMENT OF EXPENDED FUNDS

Applicants may use cash, in-kind donations and services, and volunteer labor hours to account for the total cost of the project. **Matching grant funds are only available for reimbursement on actual expenditures spent on supplies and services and not on donated items or labor.**

**GRANT FUNDS REQUESTED FROM CITY OF LONGVIEW** \$17,914.98

### ADDITIONAL PROJECT QUESTIONS

Will fees be charged in connection with using this project? <input type="checkbox"/> Yes <input checked="" type="checkbox"/> No If yes, please describe:	Multi-year project? <input type="checkbox"/> Yes <input checked="" type="checkbox"/> No (If yes, please describe)		
Anticipated Start Date: 3/16/2026	Anticipated Date of Completion: 5/30/2026		
Application completed by (print and sign name) Aaron Marthaller	<table border="1" style="width: 100%; border-collapse: collapse;"> <tr> <td style="width: 60%;">Title President</td> <td style="width: 40%;">Date 2/17/2026</td> </tr> </table>	Title President	Date 2/17/2026
Title President	Date 2/17/2026		

Please return this application by February 18, 2026 to:

**City of Longview**  
**Parks and Recreation Department**  
**2920 Douglas St.**  
**Longview, WA 98632**



# NEIGHBORHOOD PARK GRANT ESTIMATE WORKSHEET - VOLUNTEER COMMITMENT

DATE	PRINTED NAME	WORK DESCRIPTION	HOURS COMMITTED	SIGNATURE
<b>TOTAL NUMBER</b>			<b>x \$15.00</b>	

\* Volunteer Labor is calculated at \$15 per hour. Volunteer Register must match dollar amount provided for in project total.  
 \* Additional registers are available upon request if more pages are needed.

TOTAL PROJECT SUMMARY		
A.	TOTAL EXPENDITURES	\$ 35,829.99
B.	TOTAL IN-KIND DONATIONS	\$ 0
C.	TOTAL VOLUNTEER LABOR	\$ 0
<b>TOTAL PROJECT COST:</b>		<b>\$ 35,829.99</b>

**Transfer all totals from the two "Estimate Worksheets" to the table on the left for a summary of the total project cost, then transfer totals to the Project Budget and Funding page.**

TOTAL REQUEST FOR REIMBURSEMENT	
REQUEST:	\$ 17,914.98

By my signature below, I certify the information I provided on and in connection with this form is true, accurate, and complete. I also understand that any false statements or deliberate omission on this document or attached documents I submit for the Neighborhood Park Grant Program may be grounds for disqualification for reimbursement.

ORGANIZATION NAME	PRINTED NAME:	SIGNATURE:	DATE:
Longview Youth Baseball	Aaron Marthaller		2/17/2026

## **Neighborhood Parks Grant for Longview Youth Baseball**

### **1. Need**

At present, the old wooden and steel public bleacher seating is failing due to age and the effects of weather. For generations the bleachers have been maintained as best as possible, the wood planks replaced numerous times. The steel frames have been maintained as best as possible as well with repairs and paint. Over the years the bleachers were required to be modified to keep up with changing code requirements. The bleachers have been used well beyond their life expectancy and its past time to replace them. At present, the indoor batting cage has an unfinished gravel floor covered with scraps of old soccer turf. The existing flooring conditions have presented trip hazards due to uneven flooring and risks of errant balls due to unpredictable impact absorption of balls striking the flooring. Longview Youth Baseball (LYB) is requesting City of Longview Neighborhood Park grant funds to support the continued improvement of our city's youth baseball facilities. Together we serve between 300 to 500 individual unique children annually between Spring, Summer and Fall baseball activities. Children from across the socioeconomic spectrum. The proposed projects improvements are essential to improve the safety of our ball players, adult volunteers, and the viewing public. By securing this grant, we can continue to make investments into our city's youth baseball facility and enhance the experience and atmosphere for the children and adults we serve in our community as well as the many guests who visit for games and tournaments from around the region. Longview Youth Baseball is the only recreational youth baseball league that serves the children of Longview.

### **2. Community Impact**

LYB provides youth recreational baseball opportunities to all Longview children 3.5-12 years old through a structured program focusing on teamwork, skill building and friendships. Young athletes join our program from all areas of our community. Our program relies on dedicated volunteers, generous donations from sponsors, and the support of our City government. Our program draws thousands of people from all over the Pacific Northwest during the recreational season and Summer All-Star tournaments. Providing a safe and well-maintained indoor batting cage environment is critical to ensuring that all Longview student athletes are able to get their practice time in a safe environment. What's more, providing safe and weather resilient seating for our parents, families and the entire viewing public is critical to a safe experience for fans and families. Providing safe and up to date amenities ensure we can continue to draw summer teams from outside the community who will continue signing up for our tournaments and spend money in our local community. Our league is inclusive and welcomes children from all economic and gender backgrounds, ensuring every child has an opportunity to play baseball.

### **3. Access**

The Longview Youth Baseball facility is part of the City of Longview parks system at John Null Park, and it's open to the entire public, year-round. Access to facilities are gained year-round, weather dependent until field turf is one day installed, and games are played March through July, and then again August through October. The proposed new aluminum bleacher seating will be open to

everyone year-round. The indoor cage facility is open during the scheduled seasons and then closed to the public in the offseason for liability purposes. The proposed turf to be installed (over a new concrete floor) will improve and enhance access due to improved safety and enhance player experience.

#### **4. Financial Responsibility**

LYB is managed by an elected Board of Volunteers who are committed to responsible budget practices and financial oversight. The turf project is expected to last 15+ years with little maintenance beyond regular cleaning and the use of proper equipment and proper shoes on the turf itself. The bleachers are expected to last 30+ years with little maintenance beyond regular routine cleaning. Among the board member positions responsible for the preservation and maintenance of our facilities are the Safety Officer, Parks Ranger and Building Maintenance Manager. The board meets monthly year-round to discuss, review, and plan ongoing maintenance of the facility. Regular work parties are hosted involving both parents and children who spend many weekend hours maintaining our facilities.

#### **5. Cost Benefit**

The proposed cage turf and aluminum bleacher seating projects will benefit every child who practices and plays baseball at LYB, and everyone who comes to view the games. These projects are necessary for the safety of everyone who utilizes the park. The cost of inaction is an erosion of a healthy safe positive experience for the young athletes and the entire community.

#### **6. Compliance**

All proposed projects align with the City of Longview's historic preservation plan and the parks and recreation plan. These improvements will be executed in accordance with the City's guidelines to ensure they meet all necessary regulatory requirements. LYB works closely and in collaboration with the knowledgeable staff the Longview Parks and Recreation Department.

#### **7. Readiness to Proceed**

LYB is ready to purchase the necessary items and begin installation as soon as this grant is approved. Recently LYB volunteers thoroughly cleaned out the indoor batting cages and made preparations including installing a concrete floor (where previously only gravel existed.)

#### **8. Funding**

LYB receives funds through registration fees, donations from business enterprises and individuals in our community, and generous advertising sponsorships by community businesses. The money necessary for 100% of these project costs is already secured.

Map of currently registered Longview Youth Baseball participants, showing the entire City is represented.

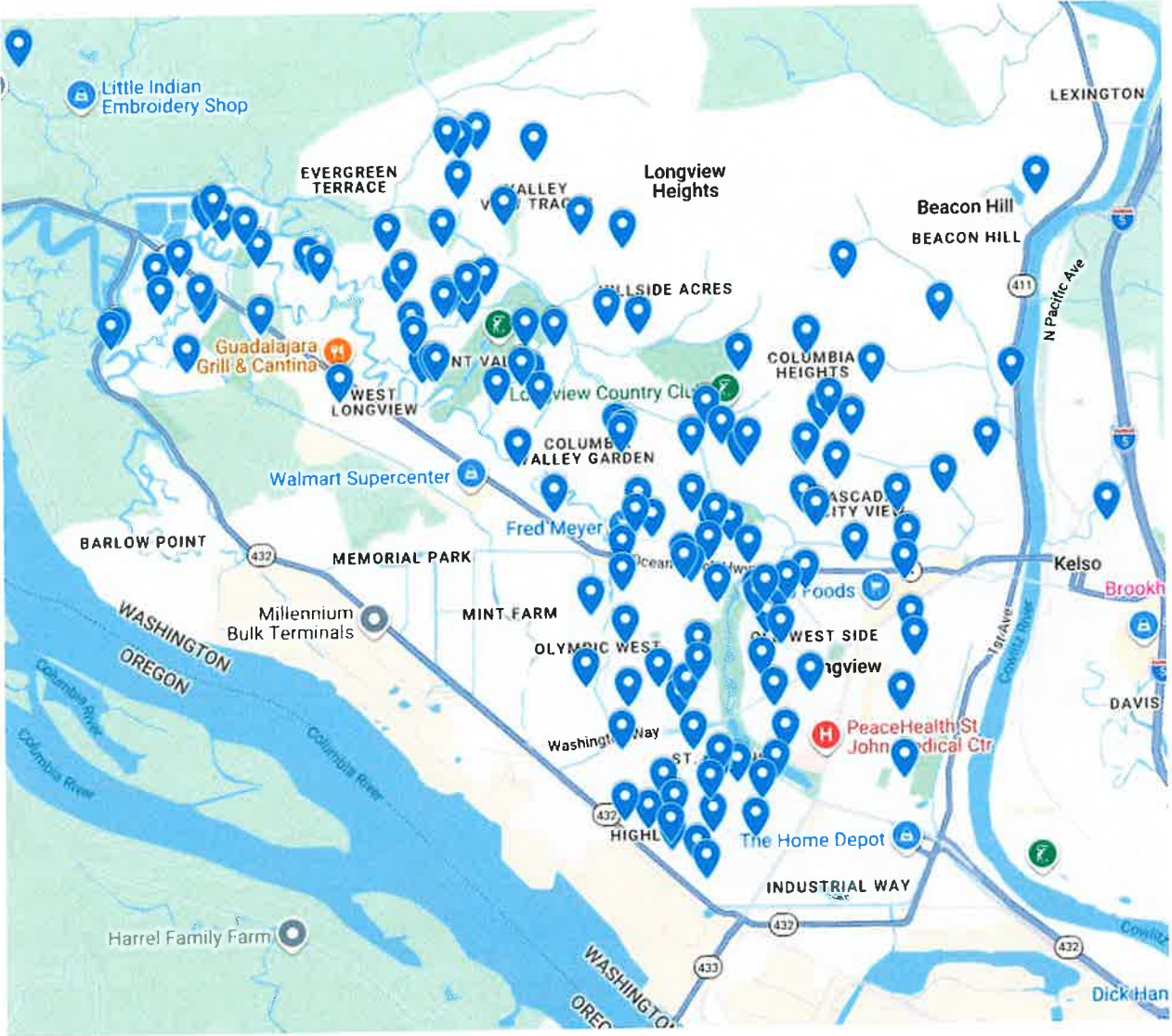

**Quote #**  
**WQ 391507**

Here is the Quote as per your request. The 'Shipping' total has been applied.  
To place an order, simply click 'Submit Order Confirmation' below.  
Please print this page for your records.  
Customer Order Confirmation is **required** to process order.



627 Amersale Drive  
Naperville, IL. 60563  
sales@belson.com

Toll Free: 1-800-323-5664  
Phone: 1-630-897-8489  
Fax: 1-630-897-0573

**QUOTE #**  
**WQ 391507**

**Expires 3/13/2026**

Model #	Description	Lbs	Quantity	Unit Price	Unit Total
BS-0315	Bleacher, 3 Row x 15'-0"L, (10" Nominal Seat Planks, 10" Nominal Tread Planks, 16" Front Row Seat Height, 6" Rise, 24" Tread), Aluminum Frame, Single Footboards Discount Applied	236	12	\$1,798.00	\$21,576.00

Subtotal	2,832	<b>Subtotal</b>	\$21,576.00
		<b>8.2000% Tax</b>	\$2,136.59
		<b>Freight - S&amp;H</b>	\$4,480.00
		<b>Grand Total</b>	\$28,192.59

Customer Order Confirmation is required to process order.

Your Order will not be shipped without your "Order Confirmation"

Bill To:

Ship To:

First/Last Name	Aaron Marthaller	Ship To	Longview Youth Baseball
Company		Address 1	2650 Pacific Way
Address 1	280 Sunset dr	Address 2	
Address 2		City	Longview
City	longview	State	WA
State	WA	Zip Code	98632
Zip Code	98632	Country	USA
Country	USA	Phone	
Phone	3604319013	Contact	Aaron Marthaller
Fax		Email	presidentlyb@gmail.com
Email	presidentlyb@gmail.com		

Additional Delivery Services

Phone Call 24 Hours Prior to Delivery

Delivery to Residential or Non-Commercial Truck Route Addresses

Power Liftgate Service - Driver will lower shipment from the truck to the ground (Only)

**Order Power Liftgate Service if — You will be unable to unload the shipment from the truck.**

**Does Not apply to UPS shipments**

Special Instructions

Intended Payment Method

 Visa <input type="radio"/>	 MasterCard <input type="radio"/>	 American Express <input type="radio"/>	 Discover <input type="radio"/>	 Check with Order <input type="radio"/>	 On Account <input type="radio"/>
--	--	--	--	--	--

Order Confirmation Method — **Customer Confirmation is Required to Complete Order**

<input checked="" type="radio"/> Email Order Confirmation	Presidentlyb@gmail.com
<input type="radio"/> Fax Order Confirmation	
<input type="radio"/> Customer Service Representative Call (M-F 8:00am - 4:30pm CST)	
What is the best day and time to call?	
Contact Name (If Different than 'Sold To')	Phone

[Submit Order Confirmation](#) [Cancel Order](#)



# Cart

Home / Cart

	Product	Price	Quantity	Subtotal
	 TFD Nylon Special Padded (5mm) Width (ft): 12 Length (ft): 60 Total Area (sq. ft.): 720	\$2,512.80	3	\$7,538.40
<input type="text" value="Coupon code"/> <input type="button" value="Apply coupon"/>				<input type="button" value="Update cart"/>

## You may be interested in...



TFD Multi Sport 5mm  
(COLORS)  
\$3.49 Per Sq. Ft.

SKU: TFD-Multi-Sport-5mm-Colors-1

[VIEW PRODUCT](#)



TFD Sportmax Edge 5mm  
\$4.25 Per Sq. Ft.  
SKU: TFD-Sportmax-Edge-5mm

[VIEW PRODUCT](#)

## Cart totals

Subtotal	\$7,538.40
Shipping	<input type="radio"/> Residential Shipping: \$99.00 <input type="radio"/> Business Shipping LESS THAN 450 sq. ft.: \$50.00 <input checked="" type="radio"/> FREE SHIPPING - Greater than 450 sq. ft. delivery to COMMERCIAL addresses only (no residential deliveries) Shipping options will be updated during checkout.
Tax (estimated for the United States (US))	Taxes will be calculated at checkout
Total	\$7,637.40
Starting at \$265/mo or 0% APR with  For Personal Use Only. See if you qualify	

[Proceed to checkout](#)

**NEIGHBORHOOD PARK GRANT APPLICATION ASSESSMENT - BEGIN ASSESSMENT HERE:**

<b>8 Rating Criteria</b>	<b>Did Applicant Address Criteria?</b>	<b>Score</b>	<b>Notes</b>
<b>Need:</b> Score based on presence of similar or complementary facilities in the area/community as well as level of need. The greater the need, the higher the score. <b>(10 Points)</b>	<input type="checkbox"/> YES <input type="checkbox"/> NO		
<b>Community Impact:</b> Score based on number of people affected, diversity, and underserved populations. The bigger the impact, the higher the score. <b>(10 Points)</b>	<input type="checkbox"/> YES <input type="checkbox"/> NO		
<b>Access:</b> Score based on public availability and year-round access, the more access, the higher score. <b>(10 Points)</b>	<input type="checkbox"/> YES <input type="checkbox"/> NO		
<b>Financial Responsibility:</b> Score based on longevity and impact on maintenance and upkeep. The longer it lasts, the less impact on the ongoing park budget /staffing time, the higher the score. <b>(10 Points)</b>	<input type="checkbox"/> YES <input type="checkbox"/> NO		
<b>Cost Benefit:</b> Score based on economic impact, community development, play opportunities, and youth issues reduction. The larger the benefit provided, the higher the score. <b>(10 Points)</b>	<input type="checkbox"/> YES <input type="checkbox"/> NO		
<b>Compliance:</b> Score based on adherence to city policies, preservation plans, and comprehensive plans. The more the project complies, the higher the score. <b>(10 Points)</b>	<input type="checkbox"/> YES <input type="checkbox"/> NO		
<b>Readiness to Proceed:</b> Score based on preparedness for installation. If the project is prepared to install or a secure plan is in place, the higher the score. <b>(20 Points)</b>	<input type="checkbox"/> YES <input type="checkbox"/> NO		
<b>Funding:</b> Score based on availability of funding or plan for securing including letters of intent from donors/partners. <b>(20 Points)</b>	<input type="checkbox"/> YES <input type="checkbox"/> NO		
	<b>Total Points:</b>		



# Longview Parks and Recreation Department Neighborhood Park Grant Application

Application deadline: February 18, 2026

PLEASE SUBMIT EIGHT (8) COPIES OF THIS APPLICATION AND  
EIGHT (8) COPIES OF ANY SUPPLEMENTAL MATERIALS

Date	Project Name	Project Location
02-18-2026	LSC Facility Repairs	927 7th Ave
Applicant (organization)		Contact Person and Title
Longview Soccer Club		Jennifer Jolly, President
Are you a non-profit organization?		If yes, what is your IRS Tax ID#?
<input checked="" type="checkbox"/> Yes <input type="checkbox"/> No		37-1641425
Address		City/State/Zip
920 7th Ave, P O Box 2054		Longview, WA 98632
Daytime Phone	Evening Phone	Email Address
360-431-1842	SAME	LSCregistrar2023@gmail.com

**Project Description.**  
(Applicants are encouraged to attach additional pages including schematic drawings, site location drawings, maps, pictures, and photographs.)

See attached word document and photos

Paint clubhouse, shed, signs. Electrical upgrades.  
Plumbing repairs.

### Project Relationship to Grant Rating and Instruction Criteria

(On a separate sheet of paper please explain how this project responds to the eight rating criteria listed in the application process. Addressing the eight criteria will enable the Parks and Recreation Advisory Board to evaluate the importance of the project against others that request funding. Failure to address the criteria will result in an incomplete application and request denial.)

- Need:** Does the community have a need for this project? (Consider whether there are similar or complementary facilities in the area/community)
- Community Impact:** Who will benefit from the project? Provide approximate number, range, and diversity of those likely to be served by or benefit from the project? Do they represent a significant underserved population?
- Access:** Upon completion, what will the availability of the project be to the public during the year?
- Financial Responsibility:** What is the potential life span of the project? What will the maintenance and replacement requirements of the project be, both immediate and long-term?
- Cost Benefit:** Do the benefits outweigh the cost of the project? (Benefits include economic impact and community development, additional opportunities for play in the community, and reduction in youth related social problems.)
- Compliance:** Does the project comply with the City of Longview's historic preservation plan, park and recreation comprehensive plan, and other city policy initiatives?
- Readiness to Proceed:** How soon after the grant is approved can the project begin? (Discuss how quickly the applicant can complete the project by demonstrating availability of the required financial match; permits being secured; and availability of needed labor.)
- Funding:** What are the applicant's potential sources of funding? (Please list all cash and in-kind goods and services) Are they already secured? Does the applicant identify partnership arrangements and what value does the partnership(s) bring to the project?

## Project Budget and Funding

### ESTIMATED BREAKDOWN OF THE PROJECT

Provide Quotes and List of Supplies	<b>COST OF PAID SUPPLIES</b>	\$ see pd services	%
Provide Quotes and Business Information	<b>COST OF PAID SERVICES</b>	\$ 20,967.05	%
Provide Estimated Number and Hours	<b>HOURS OF VOLUNTEER LABOR</b>	\$ 2400-	%
Provide Quotes and List of Supplies	<b>COST OF DONATED SUPPLIES</b>	\$ 3000	%
Provide Quotes and Business Information	<b>COST OF DONATED SERVICES</b>	\$ 18,400	%
<b>TOTAL COST OF THE PROJECT:</b>		\$ 44,767.00	

### TOTAL CASH/DONATIONS AT TIME OF APPLICATION - READINESS TO PROCEED

	<b>SECURED APPLICANT CASH:</b>	\$ 20,000-	%
*(Monetary value of all donations)	<b>SECURED APPLICANT DONATIONS:</b>	\$ 18,400-	%
*(Monetary value: 1 Hour = \$15.00)	<b>VOLUNTEER LABOR DONATION COMMITMENT: *</b>	\$ 2400-	%

10 # of Volunteers X 16 # of Hours Donated = 160 Total Hours of Volunteer Labor Donations

**TOTAL OF SECURED FUNDING/DONATION FOR THE PROJECT:** \$ 40,800.00

**\* If the total of secured funding, including donations, does not equal the total cost of the project please provide below the timeline and steps that will be taken to ensure readiness to proceed.**

The plumbing quote is high and we believe we can accomplish this more economically. The stain should be getting donated. The cost of paid supplies is included in the business quotes.

### APPLICANT REQUEST: 50% REIMBURSEMENT OF EXPENDED FUNDS

Applicants may use cash, in-kind donations and services, and volunteer labor hours to account for the total cost of the project. Matching grant funds are only available for reimbursement on actual expenditures spent on supplies and services and not on donated items or labor.

**GRANT FUNDS REQUESTED FROM CITY OF LONGVIEW:** \$ 22,383.50

### ADDITIONAL PROJECT QUESTIONS

Will fees be charged in connection with using this project? <input type="checkbox"/> Yes <input checked="" type="checkbox"/> No If yes, please describe:	Multi-year project? <input type="checkbox"/> Yes <input checked="" type="checkbox"/> No (If yes, please describe)
--	---

Anticipated Start Date: <u>3-1-2026</u>	Anticipated Date of Completion: <u>4-17-2026</u>
--	---

Application completed by (print and sign name) <u>Jennifer Jolly</u>	Title <u>President</u>	Date <u>02-18-2026</u>
---	---------------------------	---------------------------

Please return this application by February 18, 2026 to:

**City of Longview  
Parks and Recreation Department  
2920 Douglas St.  
Longview, WA 98632**

### City of Longview Neighborhood Grant

The Longview Soccer Club is applying for the Neighborhood Park Grant to repair aging facilities that the club is currently responsible for. Before I ask for the grant, I wanted to supply some brief history because I feel this could be helpful to my request.

- In 1981 the City of Longview purchased 23 acres of land to create a park for youth activities. The city then had no further funding to develop the land.
- In the Summer of 1983, the Seventh Avenue Park Development Committee was formed. This committee was made up of volunteers representing both Longview Girls Softball and Longview Soccer Club.
- This committee raised approximately \$400,000.00 of donated goods and services to develop 5 soccer fields, and 4 softball fields.
- On May 4, 1985, they held the opening ceremony of the combined parks.
- In 1993 a multipurpose building and the city bathrooms were built. The building initially housed both youth softball and youth soccer. This building is now known as the Girls Softball Clubhouse.
- As both clubs expanded it was determined a second building was needed. Auctions were held in 1997 and 2002 to raise money for an additional building.
- The building was built for the Longview Soccer Club (LSC) and was dedicated as the Blondin Building named after Frank Blondin. The building was built on volunteer donations and funding.
- The Blondin Building had been attached to the existing city bathrooms to satisfy the requirement for the building to have bathroom facilities. The bathrooms were operated and maintained by the City of Longview until the responsibility was eventually turned over to LSC (unsure the month/year this occurred). It was believed LSC was responsible for maintenance and supplies, but not for facility repairs.
- Over the past several years there have been several minor repairs to the aging plumbing, and only recently did I learn the repairs to the plumbing are also the responsibility of LSC in exchange for the use and control of the bathroom building.

I started with Longview Soccer Club in about the Spring of 1997 and became the equipment coordinator and team sponsor coordinator. I did not know the details of all the contracts and club responsibilities as there had previously been responsible people in those roles. Over the past 5 years I have become more involved with learning about club history and responsibilities. I became President of LSC in November 2025. It was shortly after this time that I learned LSC had full responsibility over the maintenance and repairs.

The LSC building and facilities need some maintenance and attention in order to protect our assets. The current LSC board members would like to get the clubhouse and facilities back into great condition. Our goal is to get as much community involvement as we can. We have had some necessary expenditures, but we have also had a lot of donations already from Cortez Landscape Inc, Watkins Tractor, Brynion Excavation, Blanco Construction, Spencer's Trucking and Sunbelt Rentals. We have reached out

to several people for costs of plumbing, painting, and electrical upgrades to match our growing needs.

**PLUMBING: \$5000.00 - \$15,580.80**

LSC reached out to several plumbers. It was explained to each plumber there is a bad smell coming from the drain in the boys bathroom when it is in high use, the first urinal in the boys bathroom is clogged and needs repair, there had been minor repairs to fix a variety of issues, and we needed to get all of the facility in proper working order without fear of what will break next. Upon looking at the facilities with different plumbers it was learned all of the rubber gaskets need replacement as they are all leaking. The plumbing being held together with zip ties need to be replaced, and all the pipes need to be cleaned out of residue and blockage. One plumber returned a bid of \$15,580.80. Two plumbers did not return a bid, a fourth plumber from Bates Plumbing recently looked at the bathrooms and gave a verbal estimate of over \$5000.00 for his part and advised All Out Sewer and Drain would have to clean out the water lines. It is yet unknown what that cost would be.

**ELECTRICAL: \$5386.45**

Division 1 electrical came to LSC. It was explained in the concession stand all the outlets on the back wall were near the bottom of the two shelves. This is problematic as it requires extension cords to be able to use kitchen appliances on the counter tops. The extension cords have been leading to overuse of the outlets. It was explained how the concession stand has grown and how the plans were to use it for this upcoming season. He gave a bid of \$1425.00 for that project. LSC purchased exterior floodlights with security cameras that can be hardwired into the building. The installation of the camera/light system was quoted \$1650.00. LSC needs electrical upgrades to the upstairs. When the building was first created we still used pen and paper to register players. Now we use 3-7 computers plugged in at any given time for registrations as well as portable heaters or portable air conditioners, and other equipment we have in the clubhouse. We would like to upgrade the aging cadet wall heaters, upgrade the outlets and add new outlets in order to safely accommodate the electrical needs. The upstairs project was quoted at \$2200.00.

**PAINTING: \$30,000.00**

LSC has been closely reviewing the facilities and determined we need to put the time and funding into protecting the current structures and buildings with new paint. Everything needs to be pressure-washed to remove dirt, mold, and moss. Then it needs to be prepped and painted. The soccer club building needs to be repainted to preserve the wood siding. None of the buildings or structures have been painted since they were built. The siding on the back of the building is also separated which can subject the underneath sections to rot. We recently made a new sign (which was donated) for the building. We have not replaced the sign as it is very noticeable how much the paint has faded over the years. The storage shed in the middle of the fields was built in about 2014. The wood siding is full of dirt and yellow moss. It needs pressure washed, sanded and painted. The wood structures at the park entrances are

also in need of pressure washing and painting in order to be preserved. Blanco Construction and Rosas Painting gave bids at \$29,000.00 and \$30,025.50

**NEED:**

There is a need to clean and paint the buildings and facilities so they do not deteriorate. There is a need to upgrade the electrical so we can better assist our soccer families. There is a need to upgrade the electrical in concessions so they can better serve the families. There is a need to repair the plumbing so we can ensure the facilities will properly work. We are currently the only dedicated soccer complex for youth.

**COMMUNITY IMPACT:**

The improvements requested will not only get our soccer families to take pride in our facilities, but the community and the city itself will hopefully become known for their great youth sports park. This project is only the beginning. We have more improvements currently being planned for this summer. The soccer club is open to all ages from u5-u18. We are trying to improve our facilities so we can hopefully increase our facility use to nightly practices. This would bring a higher demand to the facility use and hopefully grow our soccer program. If we can improve our facilities to be able to bring practices to lined fields, we can improve our coach enthusiasm to coach, we can better attend to coach and team needs, these are just naming a few benefits. The biggest overall community impact is our ability to keep soccer prices as low as possible for our soccer families.

**ACCESS:**

The LSC clubhouse is locked when club members are not present. The bathrooms are open to the public any time we open the bathrooms for soccer activities. Additionally, as Softball keeps growing their need for more available bathrooms will grow. Improving the facilities both inside and out will also make the clubhouse a more desirable place for our soccer families to host birthday parties, team parties, club meetings, soccer trainings, etc.

**FINANCIAL RESPONSIBILITIES:**

The potential life span of the project is decades. Repairing the plumbing and cleaning out the lines, cleaning and painting the structures, and upgrading the electrical can allow the existing facilities to last for years if not decades to come. It will also allow us to expand the possibilities of more ways to use our facilities.

**COST BENEFIT:**

If we do not put money into the facilities now it will cost us much more in the future. The wood on the structures is deteriorating. We can save the structures with cleaning and painting before they rot and have to be completely replaced, which would cost so much more in the future. We strive to keep our cost low so we can keep our player costs low and be able to give out scholarships to make sure all kids have a chance to play.

**COMPLIANCE:**

This piece mentions the park historic plan. In the past few months, I have come across a lot of information about club history. I intend to continually put together a timeline of the club and facility history to honor all of those involved who have helped make soccer happen in our city. There are pieces in the above timeline that I still have yet to learn, but plan to uncover. There are signs that have been made to honor those who contributed to the fields and the club. I intend to uncover or recreate those honors, but it will take some time. I believe by improving the facilities, it continues to honor those founding members who made the facilities happen in the first place. They would be proud that the club continues to take pride in what they started!

#### **READINESS TO PROCEED:**

LSC is ready to begin right now. We can start as soon as we get permission for the grant. We have a coaches meeting on March 12 with practices starting after that. The season starts April 18<sup>th</sup>. I have put a lot of facility needs into this grant because the plumbing will most likely need to be started and completed within the next few weeks. The rest we want to have completed by April 18, 2026. At this point we are just being held back pending grant approval!

#### **FUNDING:**

LSC is made up of several hard-working volunteers. I have at least 10 board members committed to volunteering an estimated 162 hours of labor hours into the facilities. We believe we can work together to have work parties to be able to get repairs and improvements completed within a month's time (weather cooperating). LSC plans to get as many in kind donations as we can, but we know there will be some out of pocket expenses. LSC has about \$20,000.00 that can be dedicated to building and facility improvements, but we also believe that we can get most of it donated. We had the painters and the electrician break the projects into separate pieces in order to get the separate projects donated by multiple sponsors.

We have already had in kind donations from Cortes Landscape Inc (fields), Brynion Excavation (fields), Sunbelt Rentals (fields), Blanco Construction (security lights installation), and VC Contractors (building roof maintenance). Rosas Painting has volunteered to donate the painting for the interior of the clubhouse. Blanco Construction has agreed to donate painting for the outside of the building. LSC volunteers will assist as needed and have volunteered to take care of the structures in the fields. We are waiting to hear back if Sherwin Williams and Rodda will donate paint and painting supplies to LSC. Bates Plumbing has agreed to some in-kind donations for plumbing, but we don't yet fully know if it will cost us to clean out all the sewer and drain lines or if we can get that service donated as well.

Longview Soccer is asking for a grant because we know there will be out of pocket expenses. We have challenged our club to get as much donated as possible. Our club members have been reaching out to the community and things are getting donated already. We have been focusing on getting the fields into shape for playing. The community sees the effort, and they are reaching out to see how they can contribute.

It's pretty exciting! A grant for the facilities will allow us to make the needed repairs and upgrades and still be able to keep our player's costs as low as possible for our families.

Thank you for your time and consideration. We look forward to partnering with the City and to make you proud of what LSC is doing with this city park!

Respectfully submitted,

Jennifer Jolly,  
Longview Soccer Club President.











# ESTIMATE

**Blanco Construction**  
PO Box 645, Longview, 98632-7416

blancoconstructionllc@yahoo.com  
+1 (360) 562-5544  
<https://www.blancoconstruction.llc/>



920 7th av

## Estimate details

Estimate no.: 1486  
Estimate date: 02/17/2026

#	Date	Product or service	Description	Qty	Rate	Amount
1.		<b>Exterior paint and siding repair</b>	Exterior cleaning and preparation to receive two coats of paint on the exterior of the club house.	1	\$13,400.00	\$13,400.00
2.		<b>Interior paint.!</b>	Club house interior paint and finishes with two coats. Interior paint t and finishes to the girls and boys bathrooms.	1	\$9,850.00	\$9,850.00
3.		<b>Outdoors shed</b>	Clean and prepare out door shed ready for paint and any exterior repairs.	1	\$4,500.00	\$4,500.00
Subtotal						\$27,750.00
Sales tax						\$2,275.50
<b>Total</b>						<b>\$30,025.50</b>

Accepted date

Accepted by

Print

PDF

Decline

Accept

# ESTIMATE

Rosas Painting  
 PO Box 1878,  
 Kalama, WA 98625  
 (360) 241-6048  
 (360) 270-8347  
 rosaslandscapingandmore@gmail.com

Longview soccer club  
 920 7th Avenue  
 Longview, WA 98632

**Estimate #** 0000192  
**Estimate Date** 02/15/2026

Item	Description	Unit Price	Quantity	Amount
Service	Exterior paint of club house	11000.00	1.00	11,000.00
Service	Replacing siding on back wall of building	5000.00	1.00	5,000.00
Service	Interior paint of club house	5000.00	1.00	5,000.00
Service	Paint interior of bathrooms (men and women)	5000.00	1.00	5,000.00
Service	Stain/paint shed located on field and the wooden frames holding the signed on the fields	3000.00	1.00	3,000.00

**NOTES:** Rosas painting is providing the above estimates according to the condition that is currently visible on the building, prices may be adjusted if there is more damage and further repairs are needed once we start prepping the building. tax has not been included in this estimate.

Power wash all surfaces on the property to be painted to remove flaking paint, dirt, and mold  
 Pressure washer psi 2500 - 4500

-Building (SIDING)- Mask up all windows with tape and plastic, cover all surrounding areas that won't be painted/stained Sand siding and trim of house with 120 grit and apply 2 coats of resilience by airless sprayer, back brushing into pores/grain to ensure solid, mechanical bond.

-Building (TRIM)-

Mask up siding with tape and plastic  
Spray x2 coats on exterior trim aka windows/soffits/fascia/frames

-Storage Shed (SIDING+TRIM)- Mask up all windows with tape and plastic, cover all surrounding areas that won't be painted/stained Sand siding and trim of house with 120 grit and apply 2 coats of Arborcoat semi solid stain by airless sprayer, back brushing into pores/grain to ensure solid, mechanical bond between substrate and coating  
Sherwin Williams Exterior acrylic a high quality exterior finish with MoistureGuard(TM) Technology for excellent early moisture resistance. This product, which has improved resistance to early dirt pick up, is recommended for use on aluminum and vinyl siding, wood siding.

**Interior Walls**

- Mask and cover as needed
- Spot prime and drywall repair
- Apply 1 coat of Sherwin Williams Satin
- Paint drywall ceilings and walls

	<b>Subtotal</b>	29,000.00
	<b>Total</b>	29,000.00
	<b>Amount Paid</b>	0.00
	<b>Estimate</b>	\$29,000.00



Service Pro Plumbing Incorporated  
 5305 NE 121ST AVE #608 Vancouver, WA 98682  
 360-727-0737

Estimate 11178692  
 Job 11134804  
 Estimate Date 12/12/2025  
 Customer PO

**Billing Address**  
 Longview Soccer Club  
 920 7th Avenue  
 Longview, WA 98632 USA

**Job Address**  
 Longview Soccer Club  
 920 7th Avenue  
 Longview, WA 98632 USA

**Estimate Details**

Repipe bathroom: Repipe the copper sections to the following fixtures with pex a piping supplied by service pro plumbing

3 toilets in the men's restroom  
 2 urinals in the men's restroom  
 1 sink in the men's restroom  
 Replace 1 air control meter for the men's restroom  
 1 main line for the men's restroom

4 toilets in the woman's restroom  
 2 sink in the women's restroom  
 Replace 2 air control meter for the women's restroom  
 1 main line for the women's restroom

Includes replacing necessary ball valves check valves, hammer arrestors, hangers and supports for the new piping  
 \*\*if pipe at main line entering the building is compromised additional costs will need to be added  
 \*\*this price does not include replacement of the vacuum breakers  
 Any sponsor ship or anything similar will need to be discussed with the owners

Service #	Description	Quantity	Your Price	Your Total
CPR-3.00.0000	Specialized Plumbing repair includes special order parts, equipment, or additional labor to complete.	12.00	\$1,200.00	\$14,400.00
<b>Potential Savings</b>				\$2,160.00
<b>Sub-Total</b>				\$14,400.00
<b>Tax</b>				\$1,180.80
<b>Total</b>				<u>\$15,580.80</u>

Thank you for choosing Service Pro Plumbing, please call the office if you have any further questions!

THIS IS AN ESTIMATE, NOT A CONTRACT FOR SERVICES. The summary above is furnished by Service Pro Plumbing Incorporated as a good faith estimate of work to be performed at the location described above and is based on our evaluation and does not include material price increases or additional labor and materials which may be required should unforeseen problems arise after the work has started. I understand that the final cost of the work may differ from the estimate, perhaps materially. THIS IS NOT A GUARANTEE OF THE FINAL PRICE OF WORK TO BE PERFORMED. I agree and authorize the work as summarized on these estimated terms, and I agree to pay the full amount for all work performed.

# ESTIMATE

Division 1 Electric & Solar  
505 Williams Finney Rd  
Kelso, WA 986269512

division1electric@gmail.com  
+1 (503) 741-6014



## Bill to

Longview Soccer Club  
920 7th Ave  
Longview, WA 98632

## Estimate details

Estimate no.: 1059  
Estimate date: 12/15/2025

Job Site: 920 7th Ave  
Project : Various Electrical projects

Date	Product or service	Description	Amount
	<b>Labor &amp; Materials</b>	<b>*** CONCESSION STAND ELECTRICAL ***</b>	<b>\$1,425.00</b>
		* Troubleshoot circuits that are available. Re run conduits throughout concession area to balance loads that will need to be used for various pieces of electrical equipment and heaters.	
		* Label all circuits as to where they are located at panel in adjacent room.	
		* Provide and install GFCI protection where necessary.	
		* Cut in outlets for (3) dedicated circuits, located in back wall of concession area, bring them up to counter height to be used more practically.	
	<b>Labor &amp; Materials</b>	<b>*** UPSTAIRS CLUBHOUSE ELECTRICAL ***</b>	<b>\$2,200.00</b>
		* Troubleshoot/replace stair landing light at top of stairs.	
		* Provide and install (4) outlets on back wall where registration takes place. This will make it easier to plug in laptops without having trip hazards.	
		* Provide and install outlets in upstairs "kitchen" area, to be able to support registration power on end and also be able to plug in kitchen equipment.	
		* Provide and install (2) quad outlets in coaches office.	

\* Provide and install (2) new cadet heaters and wall mount thermostat to control heaters.

\* Troubleshoot/fix opposite side stair landing lights that do not work.

**Labor & Materials**

\*\*\* FLOOD LIGHT CAMERAS \*\*\*

\$1,650.00

\* Install conduit, wire and boxes needed to rough in for (4) camera /lights mounted around club house.

\* Splice into existing lighting circuit, or come out of panel with new circuit to provide power to lights.

**Qualified Electrician Coupon**

Customer has applied for a \$300 rebate through QualifiedElectriciansPDX.org. Per program guidelines, the rebate discount has been applied to this invoice.

-\$300.00

Customer will submit the required rebate coupon to division1electric@gmail.com upon receipt. Please note: The coupon must be presented to the electrician at the time of service, or submitted within 7 days of service to remain eligible.

Subtotal

\$4,975.00

Sales tax

\$411.45

**Total**

**\$5,386.45**

Accepted date

Accepted by

# **Parks Maintenance & Urban Forestry Report**

## **Parks Board February 2026**

### **Parks Maintenance**

- **Tree Planting**  
Staff are currently planting 189 new trees citywide. To date, 73 trees have been planted. Planting began approximately two and a half weeks ago and is progressing on schedule.
- **Stump Grinding**  
Staff are actively grinding stumps at multiple locations. Many of these sites are being prepared for replanting, with new trees scheduled to be planted in the same locations.
- **Sennebogen Training**  
Two Parks Maintenance staff members have completed Sennebogen operational training to support expanded in-house capabilities.
- **Sharps Response (January 26)**  
Staff responded to and safely removed three sharps at Highlands Trail.

### **Urban Forestry**

- **Sennebogen Training**  
Three Urban Forestry staff members have completed Sennebogen operational training to support tree maintenance and removal operations.
- **Structural Pruning**  
Staff have been conducting structural pruning along Commerce Avenue to reduce the risk of union failures and improve long-term tree health and safety.
- **Staffing Update**  
Urban Forestry currently has a vacancy for a Lead Arborist position. Recruitment efforts are underway.

# Recreation Division

## Memo

**To:** Justin Brown  
**From:** Erin Cranston  
**Date:** February 23, 2026  
**Re:** January / February Report

---

## DIVISION HIGHLIGHTS

### Present

- Building Reservations for January 2026
  - Paid Facility Rentals – 10 rentals; \$3,322.00
- Before and After School Attendance Numbers for January
  - Kessler - 140
  - CVG - 274
  - Robert Gray – 335 AM / 265 PM
  - Northlake – 128 AM / 306 PM
- January Event Wrap Up
  - Mother Son Dance (January 31) - 202

### Future

- Upcoming Events:
  - Father Daughter Dance (February 20- 22) – Sold Out
  - Kids Fish In Sponsored by Rotary - 168 registered